

REVISIONS		
REV. NO.	DESCRIPTION	DATE

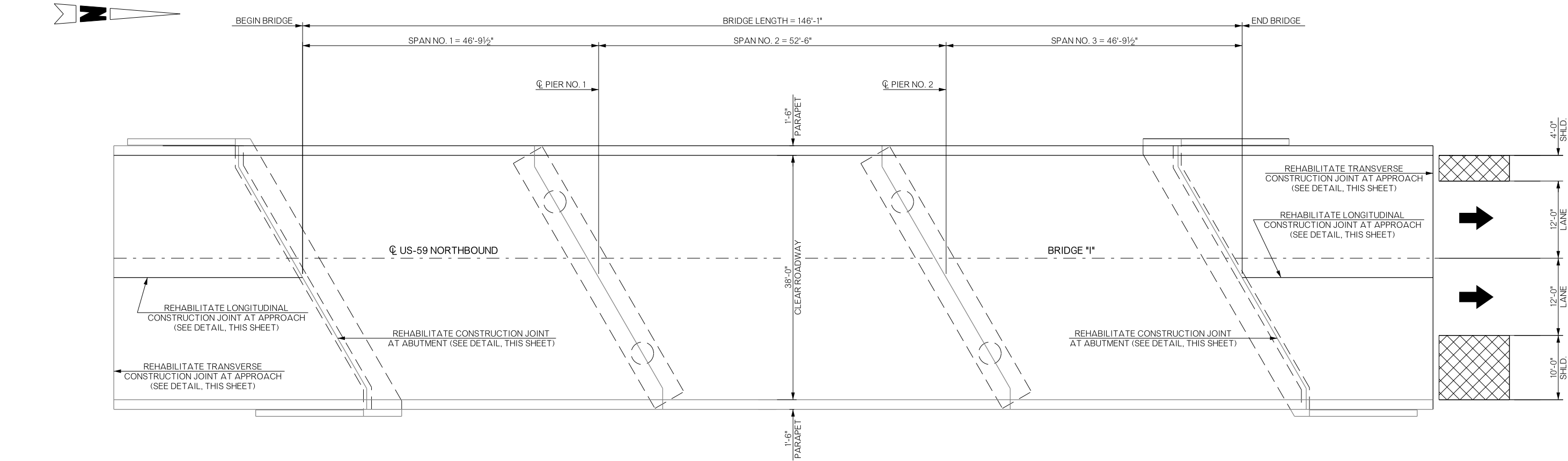

PLAN

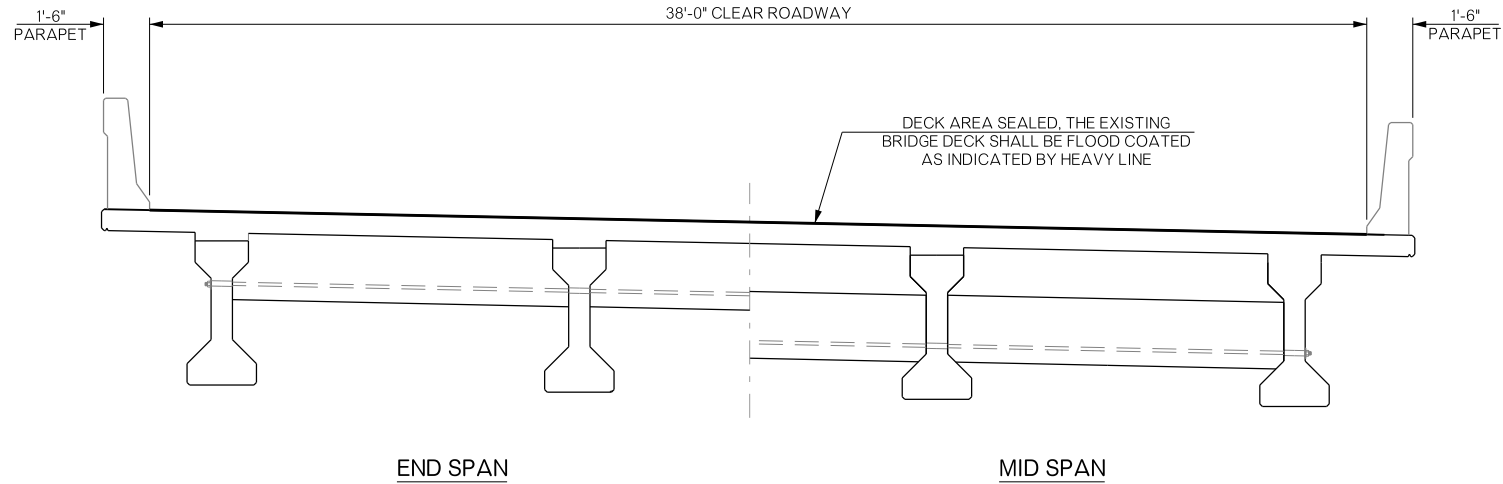

TYPICAL SECTION

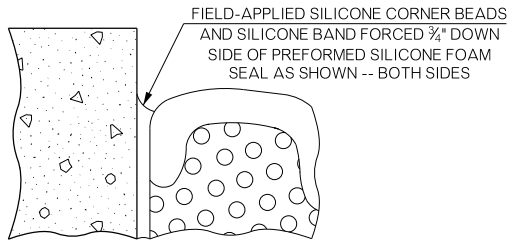

DETAIL 'A'

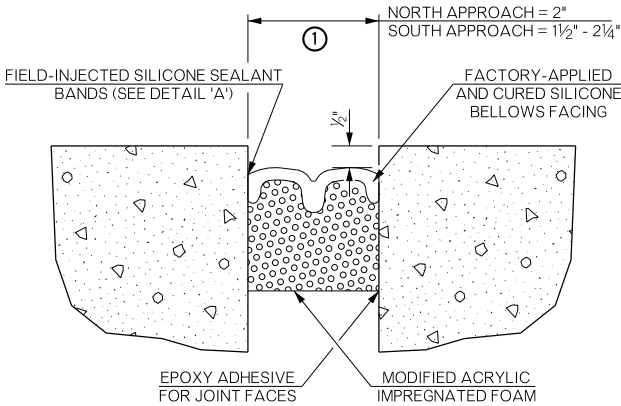

REHABILITATED TRANSVERSE  
CONSTRUCTION JOINT AT APPROACHES

① NORTH END APPROACH TO BE FOAM SEALED WITH A WIDTH AS SHOWN. SOUTH END APPROACH TO BE FOAM SEALED HAS A VARIABLE OPENING WIDTH AS SHOWN. (THESE VARIANCES SHOULD BE RESPECTED AND TAKEN INTO ACCOUNT IN THE FIELD: PREFORMED FOAM MAY NEED TO BE "STEPPED" (I.E. SECTIONED FROM DIFFERENT DEFAULT OFFERED WIDTHS.)

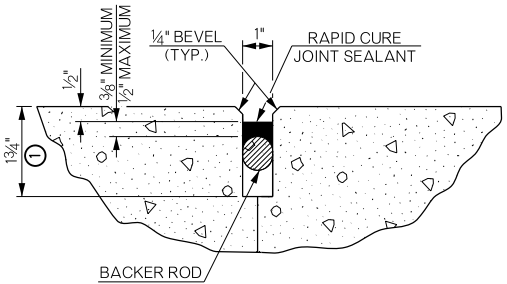

REHABILITATED CONSTRUCTION JOINT  
AT ABUTMENT AND LONGITUDINAL  
CONSTRUCTION JOINT AT APPROACHES

① SAW TO THE DEPTH SHOWN TO PROVIDE CLEAN STRAIGHT SURFACES. REFER TO LECS-4-1 STANDARD DETAIL SHEET FOR ADDITIONAL INFORMATION.

BRIDGE "I"		LE FLORE COUNTY		Design	N/A	N/A
US-59 NORTHBOUND OVER CACHE CREEK				Detail	MSW	5/17
GENERAL PLAN AND TYPICAL SECTION (BRIDGE "I")				Check	RAH	6/17
				Squad:	HENSLEY	
				Engr.:	DEFRANCO	
STATE OF OKLAHOMA		DEPARTMENT OF TRANSPORTATION				
		JOB/PIECE NO. 33217(04)				SHEET NO. B012